

LAKOTA

CHARGER



Our new Charger Editions feature a **SLEEK** new look and **TOUGHER** structure, while maintaining the **BEST OVERALL VALUE** in the industry.

Learn more at LakotaTrailers.com/Charger.



C8X17



**C8X15SRB
(9' Slide)**

C8X17



TEMPLAR ABBY WOOD INTERIOR
European Oak Floor
Bixby Saddle/Emu Bark Furniture
(Charger Upgrade Option)



LAKOTA TRAIL

C8X15SR

(Shown with optional dream dinette)



HICKORY WOOD INTERIOR
(Charger Upgrade Option)
Rustic Plank/Antique Bronze Floor
Tactile Chocolate Furniture



NEW FEATURES & HORSE AREA



New Rear Hoop with Recessed Channel for Bubble Seal

New Pearl Metallic Matte Finish

New and Improved Decal Package

New 7.5" Top Rail with Webbing to Receive Wall Upright

New Drop Down Extrusions/Design Same New Extrusion Used for Manger Doors & Escape Door

New Design Aluminum Extruded Slat (optional)



EXTERIOR

EXTERIOR COLOR OPTIONS

- Matte Silver
- Matte Black
- Matte Charcoal
- Matte White



Optional Aluminum Rims & Aluminum Slat Siding

Dropdown Windows

Outstanding Fit & Finish

Sturdy Divider Walls



FLOORPLANS

All specifications contained herein are based on the latest product information at the time of printing. Lakota reserves the right to make changes in colors, materials, equipment, and specifications at any time, without notice, and assumes no responsibility for any errors in this publication.

6' 9" WIDE

C37



C39

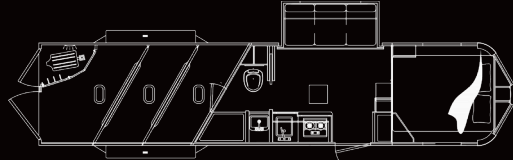

C39SR



C39 6 Cu. Ft. Fridge

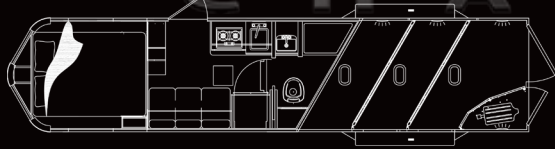

C311 Neo

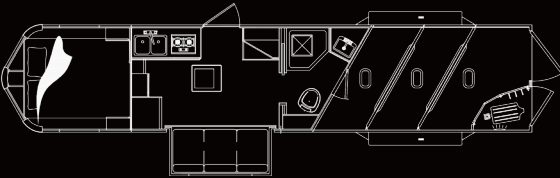

C311

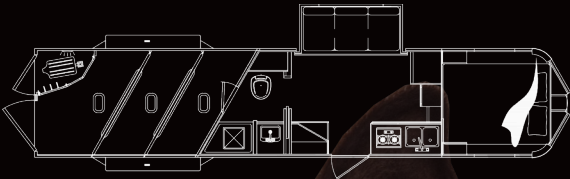

C311RK Neo

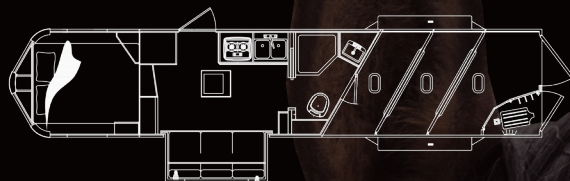

8' WIDE

C837

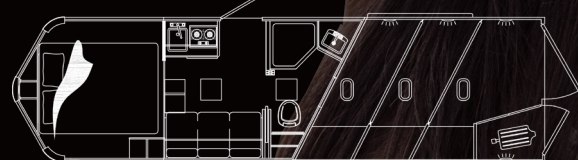

8' WIDE

C839DR



C839SR



C839 6 Cu. Ft. Fridge



C839



C8311



C8311DR



C8311RK

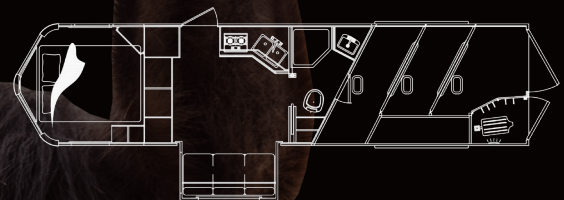

C8311SR



FLOORPLANS

8' WIDE

C8313RKB

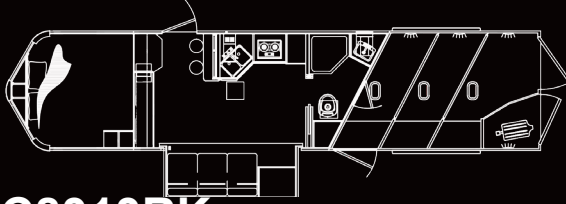

C8313RK

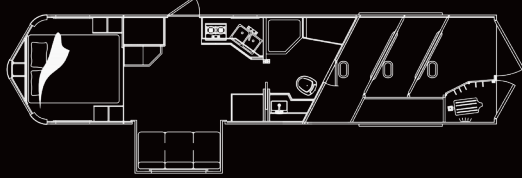

C8313RKB

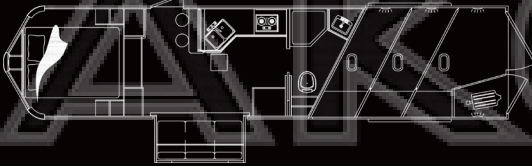

C8313SR

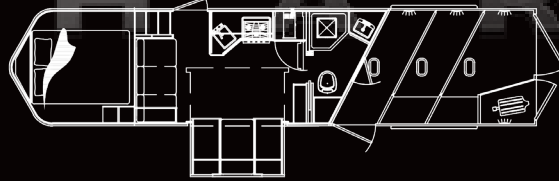

C8313.5



C8314L

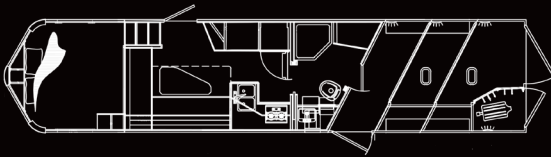

C8314CE

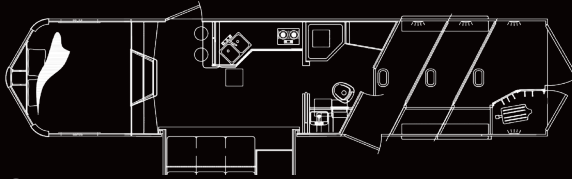

C8315BB

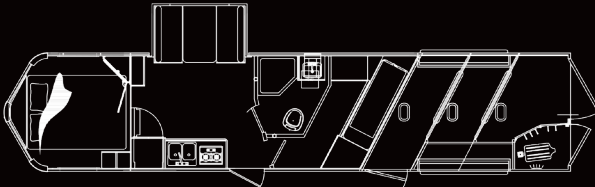

8' WIDE

C8315RKB

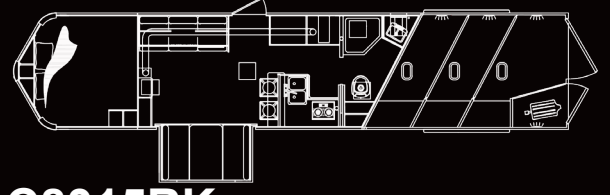

C8315RK

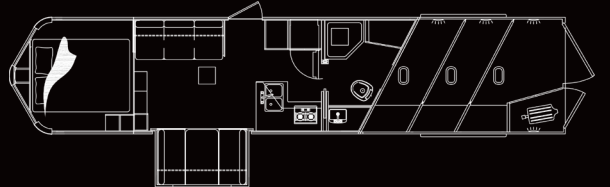

C8315SR



C8315SRB (9' Slide)

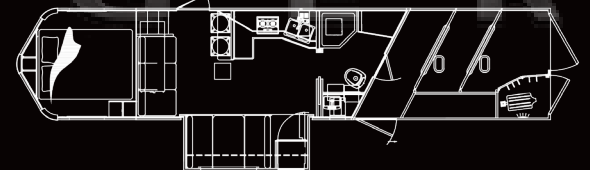

C8316BB

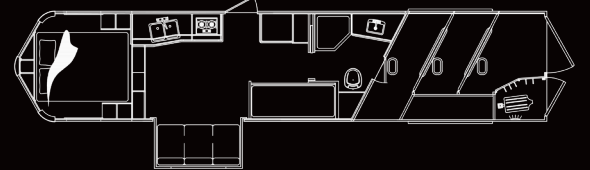

C8317

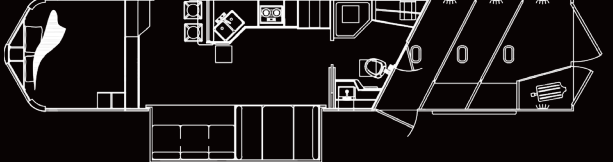

C8317SRB

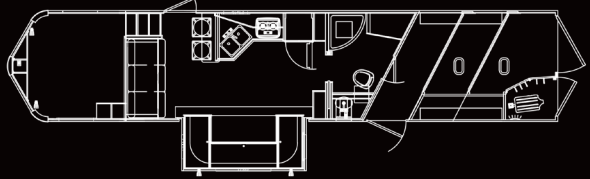

C8318CE

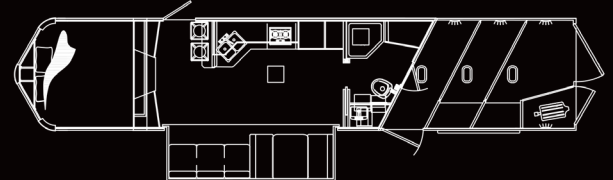

HORSE TRAILER STANDARDS

- 7'8" Tall
- 8' Wide & 6'9" Wide
- All-Aluminum Framing
- Load Light
- Radial Tires
- Saddle Tree
- Gate Springs
- Rubber Stall Matting
- LED Lights in Horse Area
- 48" Wall Lining Kick Plate
- LED Exterior and Interior Lights
- Plant Made Drop Down Feed Doors
- Swinging Blanket Bars (8' Wide)
- Two-Way Pop Up Vents (One Per Horse)
- Ramp with Dutch Doors (Straight Load)
- One Piece Aluminum Roof with Drip Rail
- 60/40 Rear Doors (Slant Load) [Opt. 50/50]
- Insulated Aluminum Walls and Ceiling in Horse Area
- Aluminum Padded Stall Dividers with Slam Latches
- Single Leg Electric/Hydraulic Jack (8' Wide)
- Power Awning with Weather Shield & LED Strip
- Exterior Package
- Side Mount Load Lights

HORSE TRAILER OPTIONS

- Single Leg Electric/Hydraulic Jack (6'9" Wide)
- Dual Electric/Hydraulic Jack (8' Wide)
- Rear Ramp
- Aluminum Wheels
- Drop Butt Windows
- Step at Escape Door
- Bridle Bar Additional

- Brush Tray Additional
- Extruded Slat Exterior
- Bauer Latch Escape Door
- Stainless Steel Wheel Covers
- Wire Blanket Bar
- Step at Rear Tack
- 3-Way Light Switch
- Additional Tail Lights
- Stainless Steel Nose Wrap
- Additional Clearance Lights
- Angled Flow Through Dividers
- Matte Exterior Color (White, Black, Charcoal, Silver)
- Full Front Riser Wall Cover (Enclosed Front End)
- Zero Degree Axles
- Goodyear Tires with Aluminum Rims

GOOSENECK LIVING QUARTER STANDARDS

- Microwave
- TV Antenna
- Wainscoting
- Refrigerator
- Bath Lavatory
- Skylight in Bath
- Black Appliances
- 4G Wi-Fi
- Sconce LED Lighting
- Mattress & Bedspread
- Queen Mattress (8' Wide)
- Night Shades with Valances
- 2 Burner Range with Hood
- 6 Gallon Gas/Electric Water Heater
- Puck Led Lighting in Ceiling
- 3/4" Tongue & Groove Floor
- Wood Grain Linoleum Floors
- R7 Spun Fiberglass Insulation

- Jack Knife Sofa (Varies by Product)
- Fresh Water Tank, Sizes Vary by Model
- Stainless Steel Kitchen Sink with Nickel Faucet
- Solid Hardwood Doors and Cabinet Faces
- Angle Shower with Glass Door (6' 9" Wide)
- Neo Shower with Glass Door (8' Wide)
- 16,000 BTU Furnace, 13,500 A/C (15' & Up 34,000 Furnace, 15,000 A/C)
- 39 Gallon Each Grey and Black Water Tanks (29 Gallon for 6' 9" Wide Models)
- Wood Counter Top Edging

LIVING QUARTER OPTIONS

- Heat Strip
- Ducted A/C
- Oven (Varies by Print)
- Hickory Interior
- Recessed Cook Top
- Lighted Grab Handle
- Automatic Satellite
- Soft Touch Walls and/or Ceiling

OTHER POPULAR OPTIONS

- Flush Floor Slideout (6', 9', or 12' depending on floorplan)
- INTERIOR PACKAGE INCLUDES: Pass-Through Door, Dual Batteries, and Rain Sensor
- ENTERTAINMENT PACKAGE INCLUDES: TV, DVD/CD/AM/FM Player, 2 Interior Speakers, and 2 Exterior Speakers
- HORSE AREA PACKAGE INCLUDES: RS Escape Door, Bottom Stall Divider, and Saddle Boss IPO Standard

Follow Us on Social Media!

@LakotaTrailers



LinkedIn YouTube



SCAN FOR MORE

WARRANTY



For more information please contact your local dealer

www.LAKOTATRAILERS.com