

LAKOTA

B I G H O R N



New Logo. Sleeker Look.
Stronger Structure.
Same Commitment To **Excellence.**

Learn More:
LakotaTrailers.com/Bighorn



IT'S A NEW ERA AT LAKOTA

In 2018, we received the NATM award for most horse trailers sold in the industry. Although this was a huge accomplishment and solidified what we already knew (that Lakota is America's favorite horse trailer), we were not satisfied with just coasting off of our previous successes.

Our team went back to the drawing board, completely redesigning our 2021-2022 Bighorn Editions with a stronger structure, new extrusions, a stouter slat, a sleek new graphics package, and numerous other upgrades and improvements. The finished product was so original, we realized that a NEW ERA had officially begun at Lakota.

Our aluminum frame construction, residential all wood cabinetry, LED exterior lighting, and countless luxury amenities make the Bighorn the best equipped horse trailer for the money in its class. With **unrivaled standard features**, a **more residential feel**, and **endless floor plans/options** to choose from, the 2021-2022 Bighorn Edition raises the bar for high-end luxury horse trailers.

See the Bighorn for yourself at your Lakota Dealer and join us in beginning this **NEW ERA** at Lakota!

All our best,

Tim Schmucker

National Sales Manager | Lakota Trailers



#1 HORSE TRAILER
MANUFACTURER
-NATM 2018



LAKOTA
BIG HORN



LAKOTA LAKOTA LAKOTA LAKOTA

0663

CC

BH8X19TBB

Shown with Optional Fireplace
U-Shaped Dinette (in place
of Sofa), & Front Cabinets (in
place of second entry to bed)



WINDSWEEP HARDWOOD INTERIOR
European Oak Floor
Namibia Saddle Soft Touch Walls / Ceiling
Donghia Black / Diviani Black Furniture



BH8X16SRB



NATURAL HICKORY WOOD INTERIOR
Rustic Plank / Antique Bronze Floor
Namibia Saddle Soft Touch Walls / Ceiling
Volney Chestnut / Lola Saddle Furniture



BH8X18CE

Shown with Optional 40" TV, Fireplace, Additional Cabinets (in place of second entry to bed and bar stools), Entertainment Recliners (in place of Sofa), & Large Single Bowl Sink



ST. LOUIS ALDER WOOD INTERIOR
European Oak Floor
Namibia Saddle Soft Touch Walls / Ceiling
Bowman Saddle / Diviani Oak Furniture



New Features & Upgraded Structure

New Rear Hoop with Recessed Channel for Bubble Seal

New Pearl Metallic Matte Finish

New 7.5" Top Rail with Webbing to Receive Wall Upright



New Drop Down Extrusions/ Design Same New Extrusion Used For Manger Door and Escape Door

New Design Aluminum Extruded Slat

New Aluminum Radius Cap (Covers Huck Bolts on Bottom Rail)

New Aluminum Radius Corners to Match Up to Radius Cap

New and Improved Decal Package with Chrome Cal



OPTIONS

The 2021-2022 Bighorn Edition features **ENDLESS** options, configurations, and ways to customize, so you can make your **LUXURIOUS** Bighorn, **YOURS!** Some of our popular options include:

Big Screen TV



Small Outdoor Kitchen



Recliners



Fireplace



Tile Backsplash



Integrated Hay Pod



HORSE AREA

Horses **LOVE** Lakota. Our horse area is known for being one of the **most comfortable** for horses in the industry.



EXTERIOR

EXTERIOR COLOR OPTIONS

-  Matte Charcoal
-  Matte Black
-  Matte Silver (Pearl)
-  Matte White



FRAMELESS WINDOWS



DROP DOWN WINDOWS



NEW LOGO WITH RAISED LETTERING



LED BACK-LIT SPEAKERS



B I G H O R N



www.LAKOTATRAILERS.com

FLOOR PLANS

BH8313SR

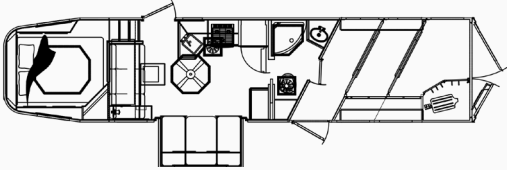

BH8313RK

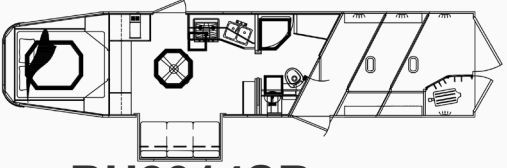

BH8314SR

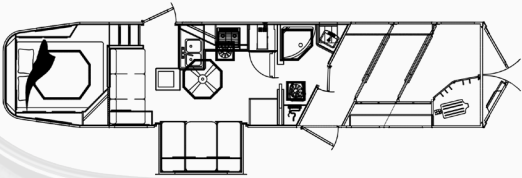

BH8314CE

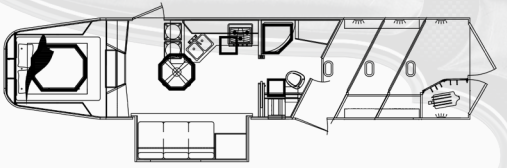

BH8315DSRK

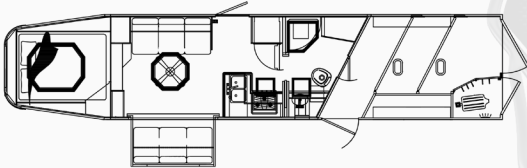

BH8315FKP

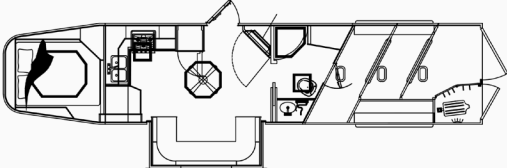

BH8316SR

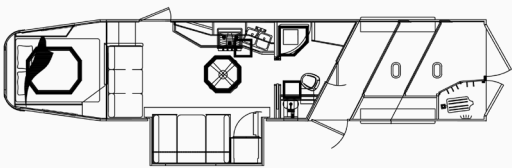

BH8316SRB

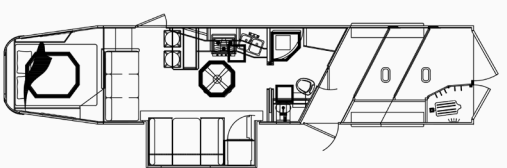

BH8317

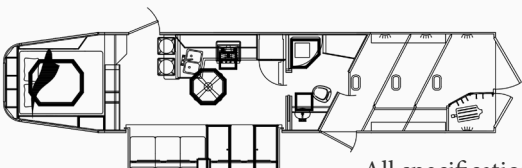

BH8317SRB

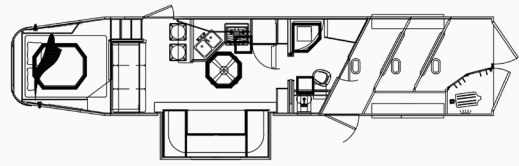

BH8317BSB

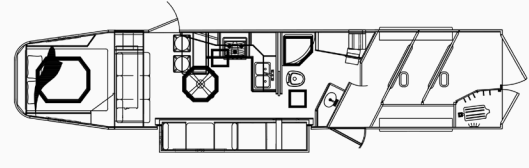

BH8318CE



BH8318MB



BH8319SROK

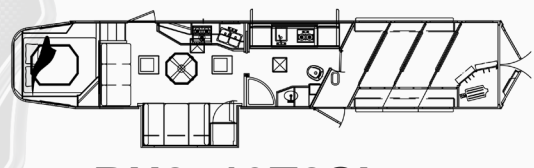

BH8419T2SI

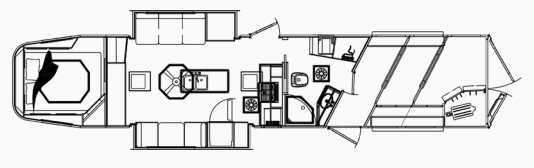

BH83192S

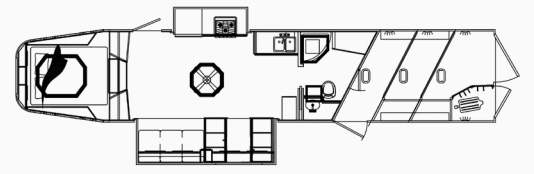

BH8419TBB

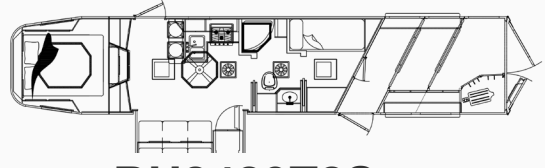

BH8423T2S

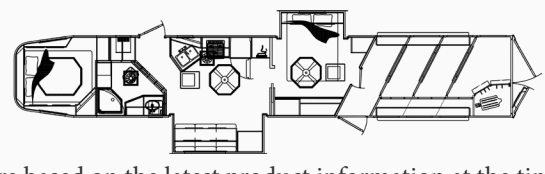

All specifications contained herein are based on the latest product information at the time of printing. Lakota reserves the right to make changes in colors, materials, equipment, and specifications at any time, without notice, and assumes no responsibility for any errors in this publication.

BIGHORN STANDARDS

INTERIOR

- Sink Covers
- 4G WI-FI
- LED Lighting
- Toe Kick Lights
- Crown Molding
- Sky Lights in Bath
- Day/Night Shades
- Hardwood Valances
- Dream Dinette (VBP)
- Sconce LED Lighting
- Complete Bedding Set
- 20K - 35K BTU Furnace
- Wood Edge Countertops
- Hidden Hinges on Cabinets
- Solid Wood Slide-Out Fascia
- Soft Touch Walls and Ceiling
- Solid Raised Panel Pocket Door w/ Mirror
- Stainless Steel Convection Microwave
- Towel Ring and Toilet Paper Holder
- Raised Panel Square Cabinet Doors
- Solid Wood Dinette and/or Sofa Ends
- 32x32 Radius Shower (Rocky Mountain)
- Stainless Steel Bath Lavatory with Nickel Faucet
- Stainless Steel Double Kitchen Sink with Nickel Pull-Out Faucet
- Insulated Floor in Living Quarters
- 15K BTU A/C with Heat Strip (VBP)
- Rustic Hickory or Alder Hardwood Cabinets & Wainscoting
- 3 Burner Recessed Cook Top w/ Oven

- 2nd Tray Ceiling With Ceiling Fan
- 10 Gal Gas/Elec. Water Heater
- Satellite Radio
- Master Control Panel
- TV and DVD Player (x2 TV for 13'+ models)
- Refrigerator with Raised Panel Door (size dependent on model)

STRUCTURE

- 8'2" Tall
- Structural 4" I-Beam
- 1.5" x 2" Closed Tube Uprights in Wall Structure
- 4" Closed Tube Bracing in Nose Structure
- Full Length Extrusion Welded to Frame of Trailer

EXTERIOR

- Stainless Steel Nose Wrap
- Tapered Nose Configuration
- Exterior Marine Stereo
- Bauer Latch on Escape Door
- Step at Escape Door
- Side Load Lights
- Two sets of LED Tail lights
- Plant Made Living Quarters Door with Retractable Screen Door
- Windows on Slide-Out End (where applicable)
- Power Awning with Weathershield + LED Light Strip + Wind Sensor
- Dual Electric/Hydraulic Jacks
- Aluminum Enclosed Battery Box
- Spare Tire and Wheel
- Dual 12v Deep Cycle Batteries
- Flush Wall Slide-Out (VBP)

- Frameless LQ Windows
- Exterior Stereo Control

HORSE AREA

- Pass Through Door to Horse Area
- Bottom Stall Divider on First Divider
- Escape Door with Drop Down Window and Face Guard
- 2 Brush Trays on Rear Tack Door
- Saddle Boss Saddle Tiers (1/Horse)
- 30" x 26" Sliding Butt Windows
- Swinging Blanket Bars
- 3 Way Switch for Horse Area Lights in Bath
- Angled Flow Through Dividers

POPULAR BIGHORN OPTIONS

- Integrated Hay Pod
- Hay Rack
- Hay Pod with Platform
- Rear Ramp
- Power Step
- Rear Side Tack
- Outside Kitchen
- 10K Torsion Axles
- Reverse Load (VBP)
- Rear Side Load (VBP)
- Swing-Out Saddle Rack
- Variety of Onan Generators
- Automatic Satellite Systems
- Different Slide-Out Sizes (VBP)
- Fully Enclosed Gooseneck Cover
- Premier Package (44" x 104" stalls)
- 8K Torsion Axles (Standard on some models)
- Drop Down Butt Windows
- Aluminum Wheels

WARRANTY

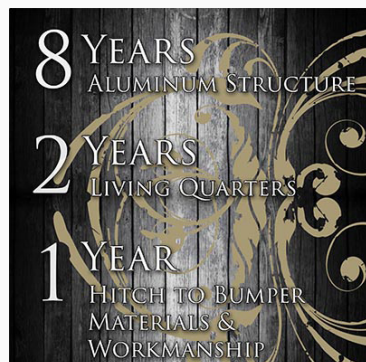

Follow Us on Social Media!
[@LakotaTrailers](#)

[LinkedIn](#) [YouTube](#)



SCAN
FOR
MORE

www.LAKOTATRAILERS.com

The image shows the interior of a Lakota horse trailer. The space is well-lit with recessed ceiling lights and a central ceiling fan. The kitchen area features a granite countertop with a stainless steel sink and faucet. A television is mounted on the wall, displaying two horses. Below the TV is a small digital display and a storage compartment. To the left, there are wooden stairs leading to an upper level. The walls and cabinets are finished with wood paneling. The floor is made of light-colored wood planks.

Lakota is proudly located in the Heartland of America. At Lakota, we incorporate American Values, toughness, and innovation into every trailer we build, and it shows. There's no better way to explore this great country than in a Lakota!



For more information please
contact your local dealer

www.LAKOTATRAILERS.com